



ANVER's ANDURASOFT® foam seal vacuum pad attachments are designed for handling rough, moderately uneven load surfaces such as saw cut or flamed stone, rough wood, fiberglass web and concrete. They can also handle smooth stone surfaces if used for both smooth and rough stone.

The ANDURASOFT® foam seals themselves fit into a snap lip so they will stay on firmly even in the vertical position. Changing seals can be done in under a minute by hand without tools making this system perfect for critical job site installation schedules. The economical replaceable ANDURASOFT® foam seals readily conform to rough, uneven surfaces to create as vacuum tight a seal as possible.

The pad attachments are rated at a conservative 22" Hg vacuum unlike the 24" Hg used on traditional cups. They are then either divided by two for horizontal or four for vertical handling. Made in USA by ANVER.

## Features

- A range of Standard Interchangeable Pad Attachments with ANDURASOFT® Foam Seals which can be quickly changed as needed with a two nut-and-bolt mounting.
- Snap lip to ensure the seal stays in position. Long lasting foam seals handle both smooth and rough stone.
- Replacing worn seals can be done in under a minute by hand without tools.
- Replacement seals are in stock for immediate shipping.
- Machined Aluminum Hubs

NOTE: Any pad attachments used with EZ-Tilt-(Series) attachments MUST USE Vertical Capacity listed. Foam sealing rings are not included with vacuum pads and attachments. They must be selected and purchased separately.

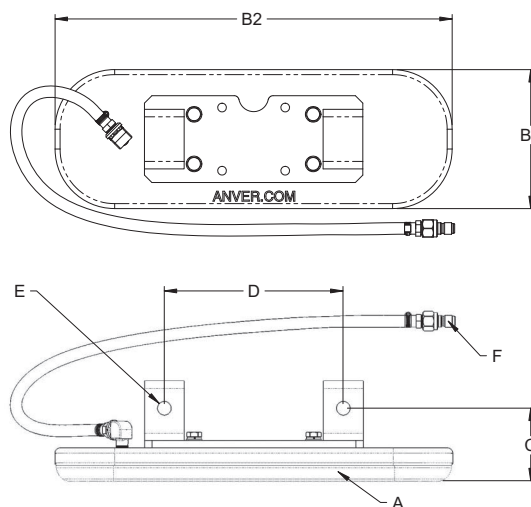

Figure F

Model Number	FPA040110G33	FPA040160G33	FPA050120G33	FPA050160G33	FPA060180G33	FPA070200G33
Horizontal Rated Load Capacity [lbs (kg)]	100 (45)	170 (77)	170 (77)	225 (102)	350 (159)	500 (227)
Vertical Rated Load Capacity [lbs (kg)]	50 (23)	85 (39)	85 (39)	112 (51)	175 (79)	250 (113)
Approx. Weight [lbs (kg)]	6.2 (3)	7.3 (3)	7.3 (3)	8.4 (4)	10.3 (5)	14.6 (7)
A Standard Seal Number	FR040110-K3R	FR040160-K3R	FR050120-K3R	FR050160-K3R	FR060180-K3R	FR070200-K1R
A Special Order Seal Number	N/A	N/A	N/A	N/A	N/A	FR070200-K2C2
B1 Pad Width [in. (mm)]	4 (102)	4 (102)	5 (127)	5 (127)	6 (152)	7.13 (181)
B2 Pad Length [in. (mm)]	11 (279)	16 (406)	12 (305)	16 (406)	18 (457)	20.13 (511)
C Headroom [in. (mm)]	2.64 (67)	2.64 (67)	2.64 (67)	2.64 (67)	2.64 (67)	3.69 (94)
D Mounting Centers [in. (mm)]	9 (229)	9 (229)	9 (229)	9 (229)	9 (229)	9 (228)
F Quick Disconnect/ Port Size	3/8 NPT	3/8 NPT	3/8 NPT	3/8 NPT	3/8 NPT	3/8 NPT
Drawing Diagram	Figure F	Figure F	Figure F	Figure F	Figure F	Figure F

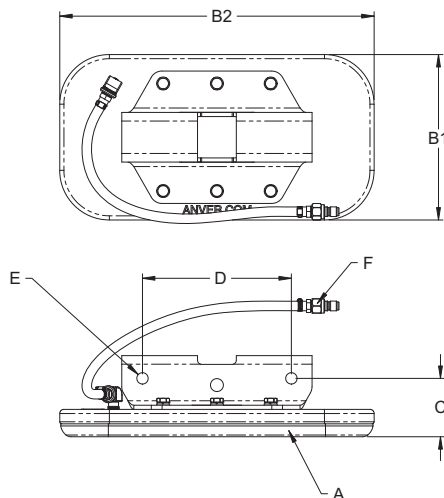

Figure G

Model Number	FPA100140G33	FPA100190G33	FPA100250G33	FPA120210G33	FPA120290G33	FPA140320G33
Horizontal Rated Load Capacity [lbs (kg)]	500 (227)	750 (340)	1000 (454)	1000 (454)	1500 (680)	2000 (907)
Vertical Rated Load Capacity [lbs (kg)]	250 (113)	375 (170)	500 (227)	500 (227)	750 (340)	1000 (454)
Approx. Weight [lbs (kg)]	18.05 (8)	22.91 (10)	32.99 (15)	33.33 (15)	45.87 (21)	54.03 (25)
A Standard Seal Number	FR100140-K1R	FR100190-K1R	FR100250-K1R	FR120210-K1R	FR120290-K1R	FR140320-K1R
A Special Order Seal Number	FR100140-K2C2	FR100190-K2C2	FR100250-K2C2	FR120210-K2C2	FR120290-K2C2	FR140320-K2C2
B1 Pad Width [in. (mm)]	10.13 (257)	10.13 (257)	10.13 (257)	12.13 (308)	12.13 (308)	14.13 (359)
B2 Pad Length [in. (mm)]	14.13 (359)	19.13 (486)	25.13 (638)	21.13 (537)	29.13 (740)	32.13 (816)
C Headroom [in. (mm)]	3.56 (90)	3.56 (90)	3.56 (90)	3.56 (90)	3.56 (90)	3.56 (90)
D Mounting Centers [in. (mm)]	9 (228)	9 (228)	9 (228)	9 (228)	9 (228)	9 (228)
F Quick Disconnect/ Port Size	3/8 NPT	3/8 NPT	3/8 NPT	3/8 NPT	1/2 NPT	1/2 NPT
Drawing Diagram	Figure G	Figure G	Figure G	Figure G	Figure G	Figure G