

ANVER's BAE1-GEN2 Series Vac-Pack Vacuum Generator contains many of the same features as the standard VPE1-GEN2 Series. Designed for use with a wide assortment of vacuum pad attachments and lifter assemblies, the BAE1-GEN2 Series includes a rechargeable, heavy duty 12 volt DC 79 amp hour battery, making it suitable for handling non-porous loads. It is commonly used for special applications where AC power is not readily available.

Your Choice of THREE Control Styles to Suit Your Application



Electric Self-Cycling Attach/Release

Instant attach/release is provided via the hoist up and down movement. The attach and release alternate each lift cycle for fast, efficient handling. Similar to our popular line of Mechanical Generators



Radio Controlled 3 Button Attach / Release / Interlock Transmitter with Plug-In Receiver

Hand held device with attach, release and safety interlock push buttons with holster mounted on front handlebar. Plug-in receiver is mounted on side of vacuum generator. Contact Factory for more information.



Plug-In Attach/Release/Interlock Control Pendant

Attach/Release momentary switch and safety interlock push-button located on control pendant with 10ft long coiled cord.



Generator shown with Radio Controls

Safety Features

- **Load Sensing Lifting Bail with Safety Lock-Out**
Pendant controls are only active when the lifter is lowered completely and there is no load on the bail. This eliminates the risk of accidental release of a suspended load by the operator. (Feature not present on the BAE1-GEN2-RD Series, which is a standalone version, or the BAE1-GEN2-T, which is a tilter version.
- **Vacuum Control Module**
A solid-state Vacuum Control Module combines all the required vacuum generator controls in one rugged unit. This controls all vacuum pump functions, safety lights and is fitted with a standard audible vacuum leakage warning system.
- **Audible Vacuum Leakage Warning System (VLS-03E)**
Integrated electronically controlled vacuum loss sensor monitors vacuum level and will sound an alarm if a slow vacuum leak is present when the vacuum level drops to a pre-determined set point.
- **Vacuum Retention**
The system includes an internal check valve to stop loss of vacuum in the event of a power failure (non-porous loads). A 627 cu. in. vacuum reservoir assists in maintaining a safe vacuum level during a power failure (non-porous loads).

Additional Features

- **Front Control Panel and Gauges**
All gauges, lights and power switches are mounted on the front of the control panel. The two vacuum gauges on the face of the panel display the level of vacuum in the manifold and in the reservoir.
- **Indicator Lights**
 - Green light indicates "safe" vacuum level.
 - Red light indicates "unsafe" vacuum level.
 - White light indicates "power on."
- **Ergonomic Control Handlebar**
Easy to grasp, large loop handlebar enables the operator to easily and safely maneuver the attached load without touching the load itself.
- **Recommended Battery Charger (CHARGER-BAE) (Sold Separately)**
The battery charger is designed specifically for today's high performance, deep-cycle lead-acid batteries. The straight blade plug accommodates a standard extension cord using a 110V AC wall outlet.

Battery Specification

- 79 Amp hour, deep-cycle battery can provide up to 8 hours of continual operation in many applications.

Vacuum Pump

- The dual 2.5 SCFM diaphragm vacuum pumps are driven by a 1/16 hp 12 volt DC motor and generates 24" Hg (at sea level) of vacuum. The ANVER Vacuum Control Module maintains a safe vacuum level by cycling the vacuum pump/motor on or off as required, which extends both the vacuum pump life and the battery charge.

Options

- **Optional Moisture Traps (32000216)**
For damp applications: prevents saturation of filter and possible damage to pump. Not for handling wet loads. Mounts on vacuum manifold.
- ***Optional Generator Configurations Available**
In reference to our standard line of Vac-Packs noted above, other configurations and set-ups are available. Contact ANVER for further information and application requirements.

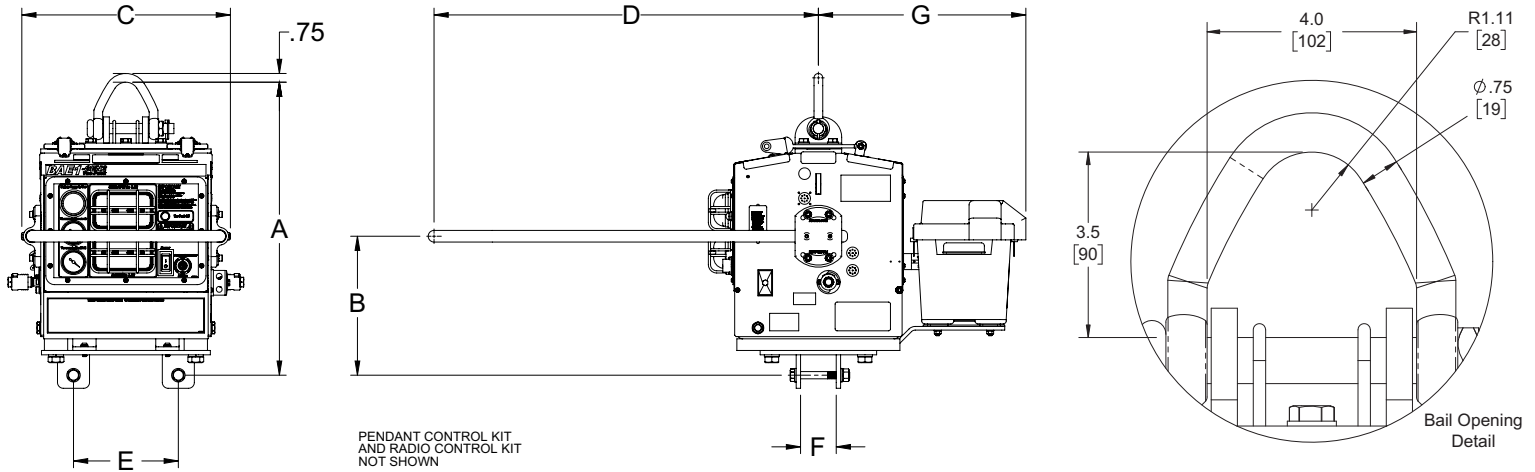

Generator Series Model No.	BAE1-GEN2-FD	BAE1-GEN2-HD	BAE1-GEN2-XD	BAE1-GEN2-XDH
Rated Load Capacity lb (kg)	2200 (998)	4600 (2087)	4600 (2087)	4600 (2087)
Unit Weight lb (kg)	260 (118)	264 (120)	270 (122)	278 (126)
A Max. Headroom in. (mm)	25.19 (640)	27.19 (691)	28.19 (716)	28.19 (716)
B Handlebar Height in. (mm)	12 (304)	14 (356)	15 (381)	15 (381)
C Handlebar Width in. (mm)	18 (457)	18 (457)	18 (457)	18 (457)
D Maximum Handlebar Length in. (mm)	33.5 (851)	33.5 (851)	33.5 (851)	33.5 (851)
E Hardware Centers in. (mm)	9 (229)	12 (305)	12 (305)	12 (305)
F Fits Tube Size in. (mm)	3 x 3 (76 x 76)	3 x 6 (76 x 152)	5 x 7 (127 x 178)	5 x 7 (127 x 178)
G Vac-Pack Depth in. (mm)	17.88 (454)	17.88 (454)	17.88 (454)	17.88 (454)
Vacuum Pump H.P.	1/16	1/16	1/16	1/16
Pump Capacity SCFM	2x 2.5	2x 2.5	2x 2.5	2x 2.5
Vacuum Level at Sea Level in. Hg	24	24	24	24
Energy Saver / Quiet Automatic Shut-Off	YES	YES	YES	YES
Battery Part Number	AGM-12V-75	AGM-12V-75	AGM-12V-75	AGM-12V-75

Choose Your Control Style Below	
Part Number	Description
ESC-AC/DC-AR	Electric Self-Cycling for Vac-Packs, Attach/Release
RCPK-AC/DC-ARI	Radio Control Kit for Vac-Packs, Attach/Release/Interlock
EPK-AC/DC-ARI	Pendant Control Kit for Vac-Packs, Attach/Release/Interlock

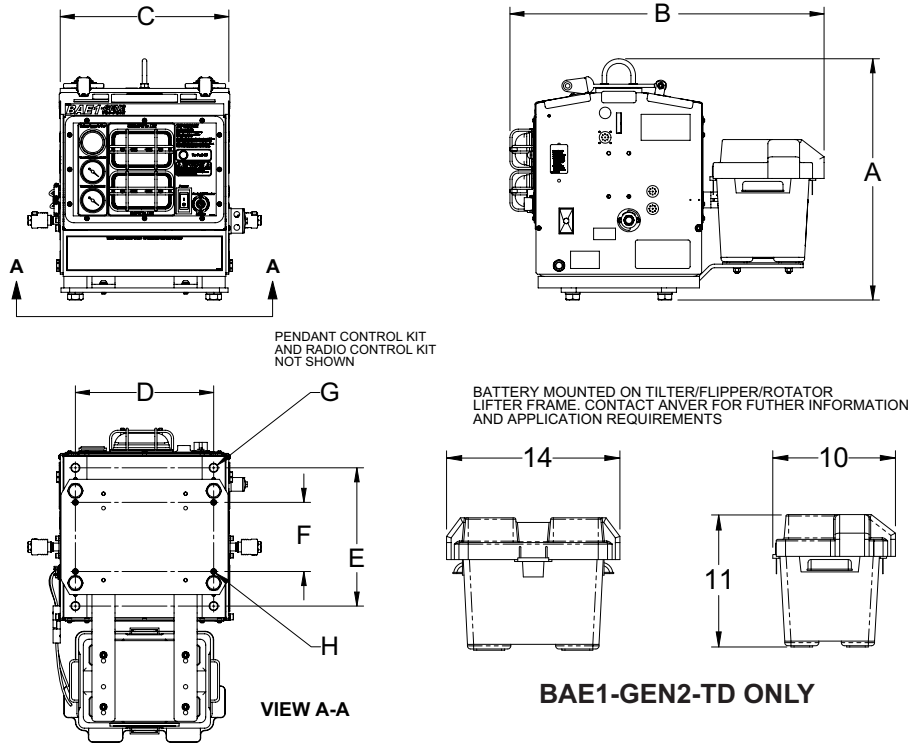

Generator Series Model No.		BAE1-GEN2-R (Remote Generator) [Battery Mounted on Generator]	BAE1-GEN2-T (Tilters/Rotators Only) [Battery Mounted on Lifter]
Unit Weight lb (kg)		256 (116)	256 (116)
A Max. Headroom in. (mm)		20.88 (530)	19.94 (506)
B Unit Depth in. (mm)		27.31 (694)	16.75 (425)
C Unit Width in. (mm)		14.63 (372)	14.63 (372)
Hardware Mounting Pattern in. (mm) Thread Size	D x E x G	12 x 12 (305 x 305) M20X2.5	
	D x F x H	12 x 6 (305 x 152) M8X1.25	
Vacuum Pump H.P.		1/16	1/16
Pump Capacity SCFM		2x 2.5	2x 2.5
Vacuum Level at Sea Level in. Hg		24	24
Energy Saver / Quiet Automatic Shut-Off		YES	YES
Battery Part Number		AGM-12V-75	AGM-12V-75

Choose Your Control Style Below	
Part Number	Description
ESC-AC/DC-AR	Electric Self-Cycling for Vac-Packs, Attach/Release
RCPK-AC/DC-ARI	Radio Control Kit for Vac-Packs, Attach/Release/Interlock
EPK-AC/DC-ARI	Pendant Control Kit for Vac-Packs, Attach/Release/Interlock