

ANVER Vacuum Lifters can be outfitted with a variety of Interchangeable Vacuum Pads and Vacuum Lifting Attachments for a wide range of material handling applications. The below Vacuum Lifting Pad Attachments feature ANVER's proprietary SSR Series of Hand Replaceable Slip-On Vacuum Sealing Rings. With SSR Sealing Rings, ANVER Vacuum Lifters are more economical to operate as the vacuum seals can easily be replaced in minutes with no tools required for removal or installation. ANVER SSR Sealing Rings also feature a short lip design for rapid vacuum attachment and release.

NOTE: Any pad attachments used with EZ-Tilt-(Series) vertical attachments MUST BE derated by 50%.

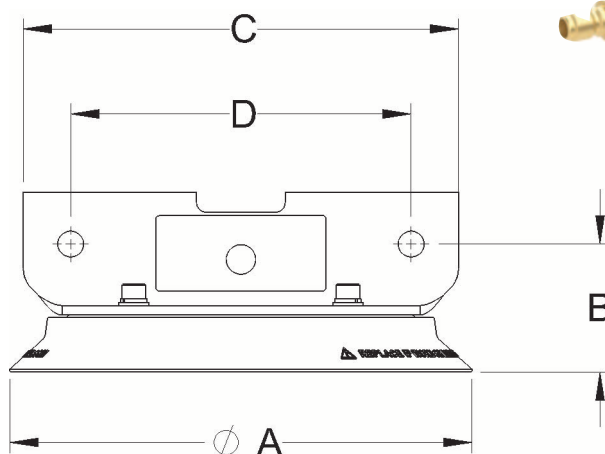
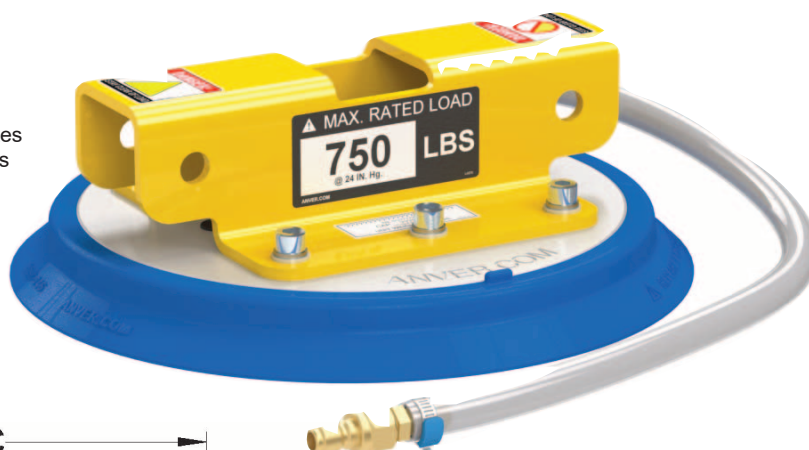

Part Number	Rated Capacity w/ M100M [lbs (kg)]	Rated Capacity w/ VPFL4 [lbs (kg)]	Rated Capacity w/ VPF57 [lbs (kg)]	Unit Weight [lbs (kg)]	A Pad Diameter [in. (mm)]	B Headroom [in. (mm)]	C Beam Length [in. (mm)]	D Mounting Centers [in. (mm)]	Replacement Vacuum Seal No.
PA66-S-3	N/A	110 (50)	110 (50)	7 (3)	6.63 (168)	3.3 (84)	12 (305)	9 (229)	SSR-66
PA72-S-3	160 (73)	160 (73)	160 (73)	8 (4)	7.0 (178)	3.25 (83)	12 (305)	9 (229)	SSR-72
PA76-S-3	160 (73)	160 (73)	160 (73)	8 (4)	7.8 (198)	3.5 (89)	12 (305)	9 (229)	SSR-76
PA82-S-3	220 (100)	220 (100)	220 (100)	8 (4)	8.0 (203)	3.0 (76)	12 (305)	9 (229)	SSR-82
PA86-S-3	220 (100)	220 (100)	220 (100)	8 (4)	8.8 (224)	3.0 (76)	12 (305)	9 (229)	SSR-86
PA92-S-3	275 (125)	275 (125)	275 (125)	14 (6)	9.13 (232)	4.0 (102)	11 (279)	9 (229)	SSR-92
PA96-S-3	275 (125)	275 (125)	275 (125)	14 (6)	10.0 (254)	4.0 (102)	11 (279)	9 (229)	SSR-96
PA122-S-3	500 (227)	500 (227)	500 (227)	18 (8)	12 (305)	3.5 (89)	11.5 (292)	9 (229)	SSR-122
PA126-S-3	500 (227)	500 (227)	500 (227)	18 (8)	12.6 (320)	3.5 (89)	11.5 (292)	9 (229)	SSR-126
PA146-S-3	750 (340)	750 (340)	750 (340)	22 (10)	15 (381)	3.5 (89)	11.5 (292)	9 (229)	SSR-146