



ANVER Vacuum and Pressure Gauges are some of the finest available for this price on the market today. They are precise, reliable, and they have a handsome chrome bezel. Their modern hi-tech look adds an air of quality to any machinery that features them.

These vacuum and pressure gauges are excellent for any vacuum application in which vacuum and/or pressure levels need to be accurately monitored. These gauges feature two mounting options within a single gauge style, offering a solution for all your application requirements: They can be center back or panel mounted, or they can be mounted below the bezel with an extension. (The model 350 Series features single mounting options.)

Features

- Accuracy 2.5% of full scale
- Black ABS plastic case with chromed bezel
- Acrylic window with dust-proof seal
- Coiled safety bourdon tube
- White dial with black pointer
- Dual scale 0 to -30 in. Hg, 0 to -100 kPa (For Pressure Gauge: 0 to 100 psi, 0 to 700 kPa)
- High quality construction

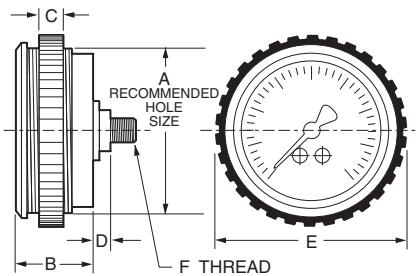

ANVER Item No.	Description	A Hole Size in. (mm)	B in. (mm)	C in. (mm)	D in. (mm)	E in. (mm)	F Actual Thread Size	Weight lb (kg)	Available Adapter for NPT to G Thread
VG150-18PBM-CW	Vacuum Gauge, 1-1/2" Dial x 1/8 NPT thread, combination center or panel back mount	1.58 (40)	1.26 (32)	0.39 (10)	0.27 (7)	1.96 (50)	1/8" NPT Male	0.13 (0.06)	1/8" NPT Female to 1/8" G Male
VG150-18PBM	Vacuum Gauge, 1-1/2" Dial x 1/8 NPT thread, combination center or panel back mount	1.58 (40)	1.26 (32)	0.39 (10)	0.27 (7)	1.96 (50)	1/8" NPT Male	0.13 (0.06)	1/8" NPT Female to 1/8" G Male
VG200-14PBM-CW	Vacuum Gauge, 2" Dial x 1/4 NPT thread, combination center or panel back mount	2.00 (51)	1.26 (32)	0.39 (10)	0.27 (7)	2.36 (60)	1/4" NPT Male	0.16 (0.07)	1/4" NPT Female to 1/4" G Male
VG200-14PBM-LF	Liquid Filled Vacuum Gauge, 2" Dial x 1/4 NPT thread, combination center or panel back mount	2.00 (51)	1.1 (28)	N/A	0.20 (5)	2.2 (56)	1/4" NPT Male	0.48 (0.22)	1/4" NPT Female to 1/4" G Male
VG200-14PBM	Vacuum Gauge, 2" Dial x 1/4 NPT thread, combination center or panel back mount	2.00 (51)	1.26 (32)	0.39 (10)	0.27 (7)	2.36 (60)	1/4" NPT Male	0.16 (0.07)	1/4" NPT Female to 1/4" G Male
VG250-14PBM-LF	Liquid Filled Vacuum Gauge, 2-1/2" Dial x 1/4 NPT thread, combination center or panel back mount	2.50 (64)	1.1 (28)	N/A	0.20 (5)	2.68 (68)	1/4" NPT Male	0.68 (0.31)	1/4" NPT Female to 1/4" G Male
VG250-14PBM	Vacuum Gauge, 2-1/2" Dial x 1/4 NPT thread, combination center or panel back mount	2.50 (64)	1.26 (32)	0.39 (10)	0.27 (7)	2.83 (72)	1/4" NPT Male	0.18 (0.08)	1/4" NPT Female to 1/4" G Male
VG350-14PBM	Vacuum Gauge, 3-5/8" Dial x 1/4 NPT thread, panel back mount	3.63 (92)	1.26 (32)	n/a	0.23 (6)	3.83 (97)	1/4" NPT Male	0.40 (0.18)	1/4" NPT Female to 1/4" G Male
VG350-14CBM	Vacuum Gauge, 3-5/8" Dial x 1/4 NPT thread, center back mount	3.63 (92)	1.28 (32.5)	n/a	0.31 (8)	3.96 (100)	1/4" NPT Male	0.54 (0.25)	1/4" NPT Female to 1/4" G Male
PG200-14PBM	Pressure Gauge, 2" Dial x 1/4 NPT thread, combination center or panel back mount	2.00 (51)	1.26 (32)	0.39 (10)	0.27 (7)	2.36 (60)	1/4" NPT Male	0.16 (0.07)	1/4" NPT Female to 1/4" G Male