

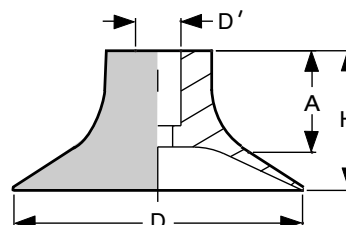

Flat vacuum suction cups attach quickly due to the small volume of air to be evacuated. They feature patterned knobs on the bottom to maximize capacity and are excellent for holding flat, flexible materials without deformation. Relatively stiff, the cup bodies retain their shape well in production applications. They are excellent for use on fast cycle transfer systems. Use on flat or slightly curved surfaces, and for horizontal or vertical lifting.

The standard materials are Nitrile (NBR) and Translucent Silicone (SIT).



Vacuum Cup Part Number and Material	D Overall Dia. in. (mm)	d Fitting Dia. in. (mm)	H Static Height in. (mm)	A Compressed Height in. (mm)	Volume in. ³ (cm ³)	Load Capacity* lb. (Kg) 2 to 1	Weight (Grams)
F3-SI (Red Silicone)	0.12 (3.0)	0.05 (1.3)	0.28 (7.0)	0.25 (6.4)	–	24 grams	–
F3-ESD (ESD NOMASTAT®)	0.12 (3.0)	0.05 (1.3)	0.28 (7.0)	0.25 (6.4)	–	24 grams	–
F3.5-SI (Red Silicone)	0.14 (3.5)	0.09 (2.2)	0.28 (7.0)	0.25 (6.4)	–	33 grams	–
F3.5-ESD (ESD NOMASTAT®)	0.14 (3.5)	0.09 (2.2)	0.28 (7.0)	0.25 (6.4)	–	33 grams	–
F4-SI (Red Silicone)	0.16 (4.0)	0.05 (1.3)	0.28 (7.0)	0.25 (6.4)	–	44 grams	–
F4-BSI (Black Silicone)	0.16 (4.0)	0.05 (1.3)	0.28 (7.0)	0.25 (6.4)	–	44 grams	–
F4-ESD (ESD NOMASTAT®)	0.16 (4.0)	0.05 (1.3)	0.28 (7.0)	0.25 (6.4)	–	44 grams	–
F4.5-SI (Red Silicone)	0.18 (4.5)	0.09 (2.2)	0.28 (7.0)	0.28 (7.0)	–	54 grams	–
F4.5-BSI (Black Silicone)	0.18 (4.5)	0.09 (2.2)	0.28 (7.0)	0.28 (7.0)	–	54 grams	–
F4.5-ESD (ESD NOMASTAT®)	0.18 (4.5)	0.09 (2.2)	0.28 (7.0)	0.28 (7.0)	–	54 grams	–
F5-NBR (Nitrile)	0.21 (5.4)	0.15 (3.8)	0.35 (9.0)	0.31 (8.0)	0.002 (0.03)	74 grams	0.24
F5-SIT (Translucent Silicone)	0.21 (5.4)	0.15 (3.8)	0.35 (9.0)	0.31 (8.0)	0.002 (0.03)	74 grams	0.24
F5.5-SI (Red Silicone)	0.22 (5.5)	0.09 (2.2)	0.28 (7.0)	0.23 (5.8)	–	78 grams	–
F5.5-BSI (Black Silicone)	0.22 (5.5)	0.09 (2.2)	0.28 (7.0)	0.33 (8.4)	–	78 grams	–
F5.5-ESD (ESD NOMASTAT®)	0.22 (5.5)	0.09 (2.2)	0.28 (7.0)	0.33 (8.4)	–	78 grams	–
F5.5-NM (ESD NOMASTAT®)	0.22 (5.5)	0.09 (2.2)	0.28 (7.0)	0.33 (8.4)	–	78 grams	–
PF6-SI (Red Silicone)	0.24 (6.0)	–	0.47 (12.0)	–	–	78 grams	–
F6.5-SI (Red Silicone)	0.26 (6.5)	0.09 (2.2)	0.28 (7.0)	–	–	105 grams	–
F6.5-BSI (Black Silicone)	0.26 (6.5)	0.09 (2.2)	0.28 (7.0)	–	–	105 grams	–
F6.5-ESD (ESD NOMASTAT®)	0.26 (6.5)	0.09 (2.2)	0.28 (7.0)	–	–	105 grams	–
F7-SI (Red Silicone)	0.28 (7.0)	0.16 (4.0)	0.47 (12.0)	–	–	121 grams	–
F7-BSI (Black Silicone)	0.28 (7.0)	0.16 (4.0)	0.47 (12.0)	–	–	121 grams	–
F7-ESD (ESD NOMASTAT®)	0.28 (7.0)	0.16 (4.0)	0.47 (12.0)	–	–	121 grams	–
F7-SIT (Translucent Silicone)	0.28 (7.0)	0.16 (4.0)	0.47 (12.0)	–	–	121 grams	–

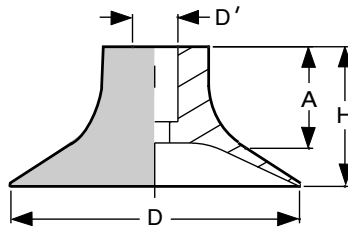

Vacuum Cup Part Number and Material	D Overall Dia. in. (mm)	d Fitting Dia. in. (mm)	H Static Height in. (mm)	A Compressed Height in. (mm)	Volume in. ³ (cm ³)	Load Capacity* lb. (Kg) 2 to 1	Weight (Grams)
F7.5-SI (Red Silicone)	0.3 (7.5)	0.09 (2.2)	0.28 (7.0)	–	–	137 grams	–
F7.5-ESD (ESD NOMASTAT®)	0.3 (7.5)	0.09 (2.2)	0.28 (7.0)	–	–	137 grams	–
F7.5-NM (NOMATHANE®)	0.3 (7.5)	0.09 (2.2)	0.28 (7.0)	–	–	137 grams	–
F8-SI (Red Silicone)	0.31 (8.0)	0.16 (4.0)	0.47 (12.0)	–	–	137 grams	–
F8-BSI (Black Silicone)	0.31 (8.0)	0.16 (4.0)	0.47 (12.0)	–	–	155 grams	–
F8-ESD (ESD NOMASTAT®)	0.31 (8.0)	0.16 (4.0)	0.47 (12.0)	–	–	155 grams	–
PF8-SI (Red Silicone)	0.31 (8.0)	–	0.47 (12.0)	–	–	155 grams	–
PF8-BSI (Black Silicone)	0.31 (8.0)	–	0.47 (12.0)	–	–	155 grams	–
PF8-ESD (ESD NOMASTAT®)	0.31 (8.0)	–	0.47 (12.0)	–	–	155 grams	–
F9-SI (Red Silicone)	0.35 (9.0)	0.16 (4.0)	0.47 (12.0)	–	–	194 grams	–
F9-BSI (Black Silicone)	0.35 (9.0)	0.16 (4.0)	0.47 (12.0)	–	–	194 grams	–
F9-ESD (ESD NOMASTAT®)	0.35 (9.0)	0.16 (4.0)	0.47 (12.0)	–	–	194 grams	–
PF9-SI (Red Silicone)	0.35 (9.0)	0.18 (4.5)	0.47 (12.0)	–	–	184 grams	–
PF9-ESD (ESD NOMASTAT®)	0.35 (9.0)	0.18 (4.5)	0.47 (12.0)	–	–	184 grams	–
PF9-NM (NOMATHANE®)	0.35 (9.0)	0.18 (4.5)	0.47 (12.0)	–	–	184 grams	–
F10-NBR (Nitrile)	0.40 (10.1)	0.16 (4.0)	0.42 (10.6)	0.37 (9.4)	0.003 (0.05)	184 grams	0.51
F10-SIT (Translucent Silicone)	0.40 (10.1)	0.16 (4.0)	0.42 (10.6)	0.37 (9.4)	0.003 (0.05)	269 grams	0.51
F10-NM (NOMATHANE®)	0.40 (10.1)	0.19 (4.7)	0.42 (10.6)	0.37 (9.4)	0.003 (0.05)	269 grams	0.51
F13-SI (Red Silicone)	0.51 (13.0)	0.16 (4.0)	0.47 (12.0)	–	–	362 grams	–
F13-ESD (ESD NOMASTAT®)	0.51 (13.0)	0.16 (4.0)	0.47 (12.0)	–	–	362 grams	–
PFL13-SI (Red Silicone)	0.53 (13.4)	0.31 (8.0)	0.48 (12.3)	–	–	405 grams	–
PFL13-ESD (ESD NOMASTAT®)	0.53 (13.4)	0.31 (8.0)	0.48 (12.3)	–	–	405 grams	–
PFL13-NM (NOMATHANE®)	0.53 (13.4)	0.31 (8.0)	0.48 (12.3)	–	–	405 grams	–
PF13-SI (Red Silicone)	0.51 (13.0)	0.18 (4.5)	0.48 (12.0)	–	–	377 grams	–
PF13-ESD (ESD NOMASTAT®)	0.51 (13.0)	0.18 (4.5)	0.48 (12.0)	–	–	377 grams	–
PF13-NM (NOMATHANE®)	0.51 (13.0)	0.18 (4.5)	0.48 (12.0)	–	–	377 grams	–

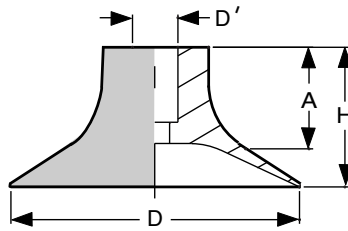

Vacuum Cup Part Number and Material	D Overall Dia. in. (mm)	d Fitting Dia. in. (mm)	H Static Height in. (mm)	A Compressed Height in. (mm)	Volume in. ³ (cm ³)	Load Capacity* lb. (Kg) 2 to 1	Weight (Grams)
F15-NBR (Nitrile)	0.58 (14.7)	0.16 (4.0)	0.43 (10.9)	0.36 (9.1)	0.011 (0.18)	515 grams	0.72
F15-SIT (Translucent Silicone)	0.58 (14.7)	0.16 (4.0)	0.43 (10.9)	0.36 (9.1)	0.011 (0.18)	515 grams	0.72
F15-NM (NOMATHANE [®])	0.58 (14.7)	0.16 (4.0)	0.43 (10.9)	0.36 (9.1)	0.011 (0.18)	515 grams	0.51
PFL16-SI (Red Silicone)	0.65 (16.5)	0.31 (8.0)	0.48 (12.3)	–	–	1.25 (0.57)	–
PFL16-ESD (ESD NOMASTAT [®])	0.65 (16.5)	0.31 (8.0)	0.48 (12.3)	–	–	1.25 (0.57)	–
PFL16-NM (NOMATHANE [®])	0.65 (16.5)	0.31 (8.0)	0.48 (12.3)	–	–	1.25 (0.57)	–
F20-NBR (Nitrile)	0.79 (20.0)	0.16 (4.0)	0.45 (11.5)	0.33 (8.5)	0.027 (0.44)	2 (0.9)	1.13
F20-SIT (Translucent Silicone)	0.79 (20.0)	0.16 (4.0)	0.45 (11.5)	0.33 (8.5)	0.027 (0.44)	2 (0.9)	1.13
F20-NM (NOMATHANE [®])	0.79 (20.0)	0.16 (4.0)	0.45 (11.5)	0.33 (8.5)	0.027 (0.44)	2 (0.9)	1.13
F25-NBR (Nitrile)	0.99 (25.1)	0.16 (4.0)	0.48 (12.1)	0.38 (9.7)	0.43 (0.70)	3.1 (1.4)	1.5
F25-SIT (Translucent Silicone)	0.99 (25.1)	0.16 (4.0)	0.48 (12.1)	0.38 (9.7)	0.43 (0.70)	3.1 (1.4)	1.5
F25-NM (NOMATHANE [®])	0.99 (25.1)	0.16 (4.0)	0.48 (12.1)	0.38 (9.7)	0.43 (0.70)	3.1 (1.4)	1.5

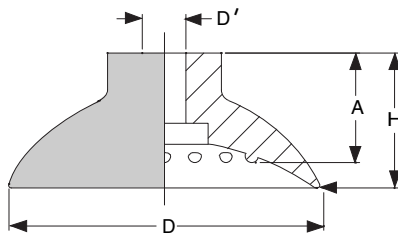

Vacuum Cup Part Number and Material	D Overall Dia. in. (mm)	d Fitting Dia. in. (mm)	H Static Height in. (mm)	A Compressed Height in. (mm)	Volume in. ³ (cm ³)	Load Capacity* lb. (Kg) 2 to 1	Weight (Grams)
F30-NBR (Nitrile)	1.17 (29.7)	0.31 (7.8)	0.75 (19.1)	0.63 (16.0)	0.177 (2.90)	4 (1.8)	4.4
F30-SIT (Translucent Silicone)	1.17 (29.7)	0.31 (7.8)	0.75 (19.1)	0.63 (16.0)	0.177 (2.90)	4 (1.8)	4.4
F35-NBR (Nitrile)	1.42 (36.0)	0.31 (7.8)	0.79 (20.0)	0.63 (16.0)	0.165 (2.70)	7 (3.2)	6.3
F35-SIT (Translucent Silicone)	1.42 (36.0)	0.31 (7.8)	0.79 (20.0)	0.63 (16.0)	0.165 (2.70)	7 (3.2)	6.3
F40-NBR (Nitrile)	1.56 (39.6)	0.31 (7.8)	0.79 (20.0)	0.63 (16.0)	0.250 (4.00)	9.5 (4.3)	7.5
F40-SIT (Translucent Silicone)	1.56 (39.6)	0.31 (7.8)	0.79 (20.0)	0.63 (16.0)	0.250 (4.00)	9.5 (4.3)	7.5

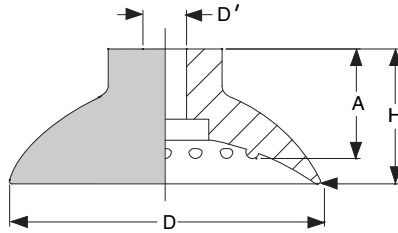

Vacuum Cup Part Number and Material	D Overall Dia. in. (mm)	d Fitting Dia. in. (mm)	H Static Height in. (mm)	A Compressed Height in. (mm)	Volume in. ³ (cm ³)	Load Capacity* lb. (Kg) 2 to 1	Weight (Grams)
F52-NBR (Nitrile)	2.05 (52.0)	0.31 (7.8)	0.87 (22.0)	0.69 (17.5)	0.427 (7.00)	12 (5.4)	13.4
F52-SIT (Translucent Silicone)	2.05 (52.0)	0.31 (7.8)	0.87 (22.0)	0.69 (17.5)	0.427 (7.00)	12 (5.4)	13.4
F60-NBR (Nitrile)	2.36 (60.0)	0.31 (7.9)	0.87 (22.0)	0.69 (17.5)	0.752 (12.00)	15 (6.8)	17.3
F60-SIT (Translucent Silicone)	2.36 (60.0)	0.31 (7.9)	0.87 (22.0)	0.69 (17.5)	0.752 (12.00)	15 (6.8)	17.3
F77-NBR (Nitrile)	2.94 (74.7)	0.46 (11.7)	1.24 (31.5)	1.02 (26.0)	0.976 (16.00)	24 (10.9)	35
F77-SIT (Translucent Silicone)	2.94 (74.7)	0.46 (11.7)	1.24 (31.5)	1.02 (26.0)	0.976 (16.00)	24 (10.9)	35
F85-NBR (Nitrile)	3.30 (85.0)	0.48 (12.0)	1.20 (31.0)	1.02 (26.0)	1.850 (30.32)	30 (13.0)	40.9
F85-SIT (Translucent Silicone)	3.30 (85.0)	0.48 (12.0)	1.20 (31.0)	1.02 (26.0)	1.850 (30.32)	30 (13.0)	40.9
F95-NBR (Nitrile)	3.74 (95.0)	0.47 (12.0)	1.46 (37.0)	1.02 (26.0)	2.899 (47.50)	40 (18.0)	49
F95-SIT (Translucent Silicone)	3.74 (95.0)	0.47 (12.0)	1.46 (37.0)	1.02 (26.0)	2.899 (47.50)	40 (18.0)	49